

mufflers

TYPE 1
CENTER IN
CENTER OUT

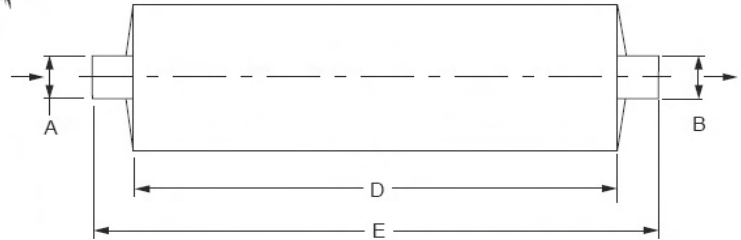

INLET/OUTLET CLOCK POSITIONS

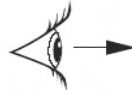
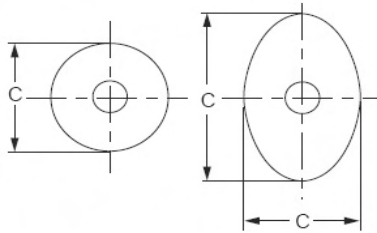
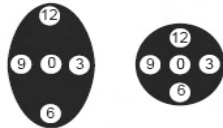

OVAL MUFFLER ROUND MUFFLER

Note: All clock positions are determined by viewing the muffler from the end view, nearest the inlet.

| PART# NUMBER | A INLET SIZE | B OUTLET SIZE | C BODY SIZE | D BODY LENGTH | E OVERALL LENGTH | F INLET OFFSET | G OUTLET OFFSET | H INLET LENGTH | INLET CLOCK POSITION | OUTLET CLOCK POSITION |
|-----------------|--------------------|---------------------|-------------------|---------------------|------------------------|----------------------|-----------------------|----------------------|----------------------------|-----------------------------|
| D14-0838 | 0.375"FL | 4"OD | 9 | 30 | 70 | 0 | 0 | 0 | 0 | 0 |
| D14-0149 | 1"NPT | 1"NPT | 3.5 | 14 | 20 | 0 | 0 | 3 | 0 | 0 |
| D15-0001 | 1.05"ID | 1.25"OD | 4 | 3.2 | 5.9 | 0 | 0 | 1.3 | 0 | 0 |
| D12-0101 | 1.125"ID | 1.125"ID | 4 | 11.75 | 15 | 0 | 0 | 1.625 | 0 | 0 |
| D14-0831 | 1.25"NPT | 1.25"ID | 4.5 | 7.5 | 12 | 0 | 0 | 2 | 0 | 0 |
| D10-0910 | 1.5"ID | 1.5"ID | 3 | 10 | 13.5 | 0 | 0 | 2 | 0 | 0 |
| D14-0190 | 1.5"ID | 1.5"ID | 3 | 14 | 19 | 0 | 0 | 2.5 | 0 | 0 |
| D15-0002 | 1.5"ID | 1.5"OD | 4 | 3.1 | 5.9 | 0 | 0 | 1.4 | 0 | 0 |
| D14-0519 | 1.5"ID | 1.5"ID | 4.5 | 13 | 17 | 0 | 0 | 2 | 0 | 0 |
| D14-0662 | 1.5"ID | 1.5" | 6 | 12 | 13 | 0 | 0 | 0.5 | 0 | 0 |
| D14-0484 | 1.5"NPT | 1.5"OD | 4 | 24 | 30 | 0 | 0 | 3 | 0 | 0 |
| D14-0468 | 1.5"NPT | 1.5"NPT | 6 | 24 | 28 | 0 | 0 | 2 | 0 | 0 |
| D10-0900 | 1.75"ID | 1.75"ID | 3 | 10 | 15 | 0 | 0 | 2.5 | 0 | 0 |
| D14-0537 | 1.75"ID | 1.75"ID | 5 | 16 | 20 | 0 | 0 | 2 | 0 | 0 |
| D12-2013 | 1.75"ID | 1.75"ID | 5 | 20 | 25 | 0 | 0 | 2.5 | 0 | 0 |
| D99-0066 | 1.75"ID | 1.75"ID | 5 | 22 | 28 | 1.5 | 1.5 | 3 | 6 | 6 |
| D99-0080 | 1.75"ID | 1.867"OD | 6 | 19.75 | 26 | 0 | 0 | 3 | 0 | 0 |
| D11-6006 | 1.75"ID | 1.75"ID | 4.25x8.75 | 6 | 10 | 0 | 0 | 2 | 0 | 0 |
| D99-0166 | 1.75"ID | 1.867"OD | 6SS | 19.75 | 26 | 0 | 0 | 3 | 0 | 0 |
| D99-0168 | 1.75F | 1.87OD | 6 | 20 | 26 | 0 | 0 | 1.5 | 0 | 0 |
| D10-0104 | 1.875"ID | 1.875"ID | 4 | 10 | 19 | 0 | 0 | 4.5 | 0 | 0 |
| D14-0326 | 1.9"ID | 2"OD | 6 | 13 | 28 | 0 | 0 | 3 | 0 | 0 |
| D13-1611 | 1.9"ID | 2"TP | 4.25x8.75 | 26 | 40.875 | 0 | 0 | 6 | 0 | 0 |
| D14-0214 | 10"ID | 10"ID | 16x22 | 32.25 | 40 | 4.5625 | 4.5625 | 4 | 6 | 6 |
| D10-0902 | 2"ID | 2"ID | 3 | 10 | 15 | 0 | 0 | 2.5 | 0 | 0 |
| D10-0103 | 2"ID | 2"ID | 4 | 12 | 21 | 0 | 0 | 4.5 | 0 | 0 |
| D10-0113 | 2"ID | 2"ID | 4 | 17 | 25 | 0 | 0 | 4 | 0 | 0 |
| D10-0118 | 2"ID | 2.25"ID | 4 | 17 | 25 | 0 | 0 | 4 | 0 | 0 |
| D10-0123 | 2"ID | 2"ID | 4 | 24 | 32 | 0 | 0 | 4 | 0 | 0 |
| D99-0165 | 2"ID | 2"ID | 4 | 24 | 28 | 0 | 0 | 2 | 0 | 0 |
| D14-0200 | 2"ID | 2"ID | 4.5 | 10 | 16 | 0 | 0 | 3 | 0 | 0 |
| D15-0003 | 2"ID | 2"ID | 6 | 5 | 11.13 | 0 | 0 | 2 | 0 | 0 |

mufflers

TYPE 1 CENTER IN CENTER OUT

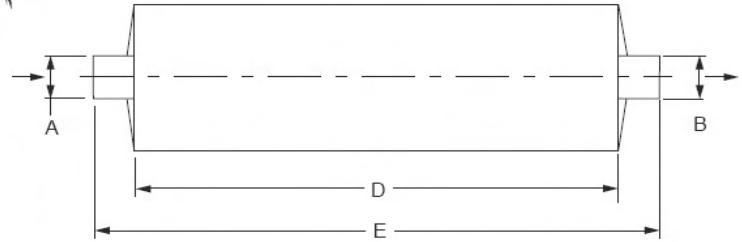
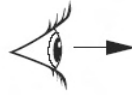
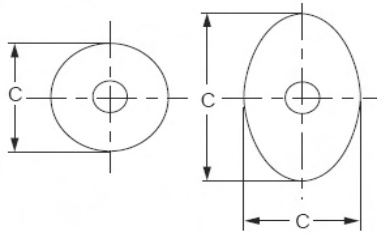

INLET/OUTLET CLOCK POSITIONS

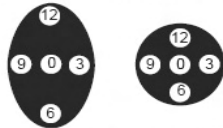

OVAL MUFFLER ROUND MUFFLER

Note: All clock positions are determined by viewing the muffler from the end view, nearest the inlet.

| PART# NUMBER | A INLET SIZE | B OUTLET SIZE | C BODY SIZE | D BODY LENGTH | E OVERALL LENGTH | F INLET OFFSET | G OUTLET OFFSET | H INLET LENGTH | INLET CLOCK POSITION | OUTLET CLOCK POSITION |
|-----------------|--------------------|---------------------|-------------------|---------------------|------------------------|----------------------|-----------------------|----------------------|----------------------------|-----------------------------|
| D14-0673 | 2"ID | 2"OD | 6 | 13 | 34 | 0.75 | 0.75 | 9 | 12 | 12 |
| D14-0244 | 2"ID | 2"ID | 6 | 16 | 21 | 0 | 0 | 2.5 | 0 | 0 |
| D14-0917 | 2"ID | 2"ID | 6 | 16 | 21 | 0 | 0 | 2 | 0 | 0 |
| D14-0185 | 2"ID | 2"TP | 6 | 18 | 32.5 | 0 | 0 | 3 | 0 | 0 |
| D12-0108 | 2"ID | 2"ID | 4.5x11 | 19.375 | 26 | 0 | 0 | 3.3125 | 0 | 0 |
| D12-5033 | 2"ID | 2"ID | 4.5x11 | 19.375 | 26.5 | 0 | 0 | 3.5 | 0 | 0 |
| D14-0139 | 2"ID | 2"ID | 4.25x8.75 | 12.5 | 16.25 | 2.25 | 2.25 | 2.25 | 6 | 6 |
| D14-0047 | 2"ID | 2"ID | 4.25x8.75 | 13.25 | 24.25 | 0 | 0 | 1.5 | 0 | 0 |
| D10-1000 | 2"OD | 2"OD | 3 | 16 | 22 | 0 | 0 | 3 | 0 | 0 |
| D14-0766 | 2"OD | 2"OD | 6 | 12 | 16 | 0 | 0 | 2 | 0 | 0 |
| D14-0520 | 2.125"ID | 2.25"ID | 6 | 24 | 36.5 | 0 | 0 | 8 | 0 | 0 |
| D10-0105 | 2.25"ID | 2"OD | 4 | 17 | 25 | 0 | 0 | 4 | 0 | 0 |
| D10-0114 | 2.25"ID | 2.25"ID | 4 | 17 | 25 | 0 | 0 | 4 | 0 | 0 |
| D10-0124 | 2.25"ID | 2.25"ID | 4 | 24 | 32 | 0 | 0 | 4 | 0 | 0 |
| D10-0125 | 2.25"ID | 2.5"ID | 4 | 24 | 32 | 0 | 0 | 4 | 0 | 0 |
| D14-0106 | 2.25"ID | 2.25"ID | 6 | 19.5 | 25.5 | 0 | 0 | 3 | 0 | 0 |
| D14-0110 | 2.25"ID | 2.25"ID | 6 | 19.5 | 25.5 | 0 | 0 | 3 | 0 | 0 |
| D14-0661 | 2.25"ID | 2.25"ID | 8 | 23 | 30 | 0 | 0 | 3 | 0 | 0 |
| D14-0060 | 2.25"ID | 2.25"ID | 4.25x8.75 | 13.25 | 24.25 | 0 | 0 | 1.5 | 0 | 0 |
| D11-6002 | 2.25"ID | 2.25"ID | 4.25x8.75 | 14 | 20 | 0 | 0 | 3 | 0 | 0 |
| D14-0142 | 2.25"OD | 2.25"OD | 6 | 13 | 19 | 0 | 0 | 3 | 0 | 0 |
| D14-0474 | 2.25"OD | 2.25"ID | 6 | 20 | 26.5 | 0 | 0 | 3.25 | 0 | 0 |
| D13-1576 | 2.25F | 2.25"OD | 8 | 19.5 | 25.75 | 0 | 0 | 3 | 0 | 0 |
| D14-0464 | 2.4"ID | 2.5"OD | 4 | 26 | 36 | 0 | 0 | 4 | 0 | 0 |
| D12-2005 | 2.4"ID | 2.25"OD | 7 | 19.375 | 26.375 | 0 | 0 | 3.5 | 0 | 0 |
| D10-0119 | 2.5"ID | 2.25"ID | 4 | 17 | 25 | 0 | 0 | 4 | 0 | 0 |
| D10-0128 | 2.5"ID | 2.5"OD | 4 | 24 | 32 | 0 | 0 | 4 | 0 | 0 |
| D10-0130 | 2.5"ID | 2.5"ID | 4 | 24 | 32 | 0 | 0 | 4 | 0 | 0 |
| D14-0171 | 2.5"ID | 2.5"OD | 5 | 17 | 27 | 0 | 0 | 4 | 0 | 0 |
| D99-0029 | 2.5"ID | 2.5"ID | 6 | 12 | 15 | 0 | 0 | 1.5 | 0 | 0 |
| D13-7601 | 2.5"ID | 2.5"ID | 6 | 22 | 29 | 0 | 0 | 4.5 | 0 | 0 |
| D12-4000 | 2.5"ID | 2.5"ID | 6 | 26.5 | 33.5 | 0 | 0 | 3.5 | 0 | 0 |

mufflers

TYPE 1
CENTER IN
CENTER OUT

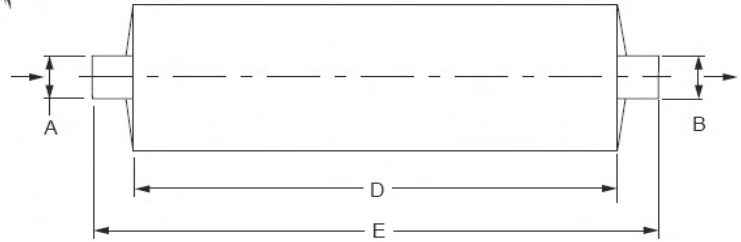
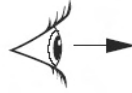
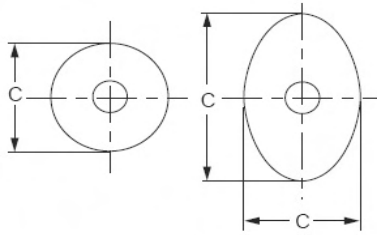

INLET/OUTLET CLOCK POSITIONS

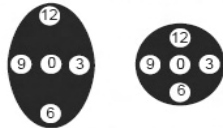

OVAL MUFFLER ROUND MUFFLER

Note: All clock positions are determined by viewing the muffler from the end view, nearest the inlet.

| PART# NUMBER | A INLET SIZE | B OUTLET SIZE | C BODY SIZE | D BODY LENGTH | E OVERALL LENGTH | F INLET OFFSET | G OUTLET OFFSET | H INLET LENGTH | INLET CLOCK POSITION | OUTLET CLOCK POSITION |
|-----------------|--------------------|---------------------|-------------------|---------------------|------------------------|----------------------|-----------------------|----------------------|----------------------------|-----------------------------|
| D99-0010 | 2.5"ID | 2.5"ID | 6 | 26.5 | 33.5 | 0 | 0 | 3.5 | 0 | 0 |
| D15-0004 | 2.5"ID | 2.5"ID | 6.5 | 6.25 | 13 | 0 | 0 | 2 | 0 | 0 |
| D12-4009 | 2.5"ID | 2.5"ID | 7 | 26.5 | 32.5 | 0 | 0 | 3 | 0 | 0 |
| D12-2024 | 2.5"ID | 2.5"OD | 10 | 8 | 13 | 0 | 0 | 2.5 | 0 | 0 |
| D14-0543 | 2.5"ID | 2.5"OD | 10 | 9 | 15.5 | 0 | 0 | 3 | 0 | 0 |
| D12-2107 | 2.5"ID | 2.5"ID | 4.25x8.75 | 11.5 | 17.5 | 2.625 | 2.625 | 3 | 12 | 12 |
| D14-0076 | 2.5"ID | 2.5"ID | 4.25x8.75 | 13.25 | 24.25 | 0 | 0 | 1.5 | 0 | 0 |
| D14-0703 | 2.5"ID | 3"ID | 6x10 | 24 | 35 | 0 | 0 | 8 | 0 | 0 |
| D14-0756 | 2.5"ID | 2.25"OD | 8.25x11.5 | 8 | 15 | 0 | 0 | 3.5 | 0 | 0 |
| D14-0024 | 2.5"OD | 2.25"OD | 7 | 12 | 19.5 | 0 | 0 | 3.25 | 0 | 0 |
| D14-0889 | 2.5"OD | 2.5"OD | 7 | 14.5 | 24 | 0 | 0 | 4" | 0 | 0 |
| D13-0087 | 2.5"OD | 2.25"ID | 8 | 22 | 28.5 | 0 | 0 | 3.25 | 0 | 0 |
| D13-1514 | 2.5"ODF | 2.25"ID | 8.5 | 23 | 28 | 0 | 0 | 2 | 0 | 0 |
| D12-4007 | 2.75"ID | 2.75"ID | 7 | 30 | 36 | 0 | 0 | 3 | 0 | 0 |
| D12-4008 | 2.75"ID | 2.75"ID | 7 | 30 | 36 | 0 | 0 | 3 | 0 | 0 |
| D14-0287 | 2.75"ID | 2.75"OD | 8 | 17.5 | 27 | 0 | 0 | 4 | 0 | 0 |
| D13-0042 | 2.75"ID | 2.75"OD | 8.5 | 22 | 32 | 0 | 0 | 6 | 0 | 0 |
| D14-0841 | 2.75"IDFL | 2.5"OD | 4 | 19 | 34 | 0 | 0 | 8 | 0 | 0 |
| D14-0332 | 2.9"ID | 3"OD | 6x10 | 26 | 43.1 | 0 | 0 | 13.2 | 0 | 0 |
| D99-0031 | 3"EL | 2.75"ID | 6 | 26.5 | 45 | 0 | 0 | 15 | 0 | 0 |
| D99-0032 | 3"EL | 2.75"ID | 6 | 26.5 | 45 | 0 | 0 | 15 | 0 | 0 |
| D14-0151 | 3"EL | 3"EL | 7 | 26.5 | 33.5 | 0 | 0 | See | 0 | 0 |
| D14-0140 | 3"F | 3"ID | 8 | 26.5 | 36.5 | 0 | 0 | 3 | 0 | 0 |
| D14-0120 | 3"F | 3"OD | 8 | 29.5 | 47.5 | 0 | 0 | 0 | 0 | 0 |
| D14-0085 | 3"F | 3.5"OD | 8 | 30 | 39.5 | 0 | 0 | 2.5 | 0 | 0 |
| D14-0284 | 3"FL | 2.5"EL | 6 | 21 | 42 | 0 | 0 | 2.5 | 0 | 0 |
| D14-0010 | 3"FL | 3"OD | 7 | 33 | 50 | 0 | 0 | 2.5 | 0 | 0 |
| D10-0131 | 3"ID | 3"ID | 3.5 | 16 | 22 | 0 | 0 | 3 | 0 | 0 |
| D10-0132 | 3"ID | 3"ID | 3.5 | 20 | 26 | 0 | 0 | 3 | 0 | 0 |
| D10-0133 | 3"ID | 3"ID | 3.5 | 26 | 32 | 0 | 0 | 3 | 0 | 0 |
| D99-0096 | 3"ID | 2.75"ID | 4 | 17 | 24.5 | 0 | 0 | 3 | 0 | 0 |
| D10-0117 | 3"ID | 3"ID | 4 | 18 | 25 | 0 | 0 | 3.5 | 0 | 0 |

mufflers

TYPE 1
CENTER IN
CENTER OUT

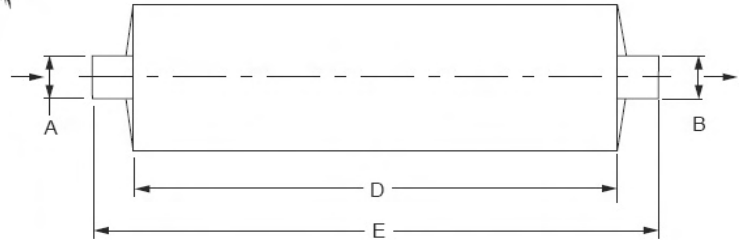
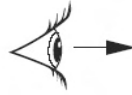
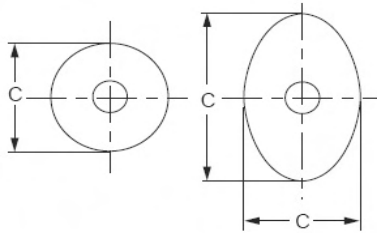

INLET/OUTLET CLOCK POSITIONS

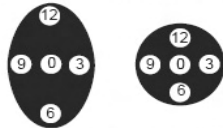

OVAL MUFFLER ROUND MUFFLER

Note: All clock positions are determined by viewing the muffler from the end view, nearest the inlet.

| PART# NUMBER | A INLET SIZE | B OUTLET SIZE | C BODY SIZE | D BODY LENGTH | E OVERALL LENGTH | F INLET OFFSET | G OUTLET OFFSET | H INLET LENGTH | INLET CLOCK POSITION | OUTLET CLOCK POSITION |
|-----------------|--------------------|---------------------|-------------------|---------------------|------------------------|----------------------|-----------------------|----------------------|----------------------------|-----------------------------|
| D13-1515 | 3"ID | 3"ID | 5 | 24 | 36 | 0 | 0 | 5 | 0 | 0 |
| D13-7602 | 3"ID | 3"ID | 6 | 21 | 30 | 0 | 0 | 4 | 0 | 0 |
| D14-0508 | 3"ID | 3"OD | 6 | 32 | 50.5 | 0 | 0 | 6.25 | 0 | 0 |
| D15-0005 | 3"ID | 3"ID | 7 | 7.63 | 14.63 | 0 | 0 | 2 | 0 | 0 |
| D14-0288 | 3"ID | 3"TP | 7 | 21 | 27 | 0 | 0 | 3 | 0 | 0 |
| D12-4006 | 3"ID | 3"ID | 7 | 22 | 28 | 0 | 0 | 3 | 0 | 0 |
| D13-4824 | 3"ID | 3"ID | 7 | 24 | 30 | 0 | 0 | 3 | 0 | 0 |
| D14-0198 | 3"ID | 4"ID | 7 | 24 | 38 | 0 | 0 | 10 | 0 | 0 |
| D12-4004 | 3"ID | 3"ID | 7 | 26.5 | 33 | 0 | 0 | 3 | 0 | 0 |
| D12-4005 | 3"ID | 3"ID | 7 | 26.5 | 32.5 | 0 | 0 | 3 | 0 | 0 |
| D12-4002 | 3"ID | 3"ID | 7 | 30 | 36 | 0 | 0 | 3 | 0 | 0 |
| D14-0063 | 3"ID | 3"OD | 8 | 11.5 | 21 | 0 | 0 | 3.5 | 0 | 0 |
| D14-0021 | 3"ID | 3"OD | 8 | 12 | 44 | 0 | 0 | 5 | 0 | 0 |
| D99-0052 | 3"ID | 3"ID | 8 | 24 | 29 | 0 | 0 | 2 | 0 | 0 |
| D13-2087 | 3"ID | 2.75"OD | 8 | 38 | 47.5 | 0 | 0 | 3.5 | 0 | 0 |
| D14-0289 | 3"ID | 3"OD | 8.5 | 12.4 | 19.1 | 0 | 0 | 2 | 0 | 0 |
| D14-1012 | 3"ID | 3"ID | 8.5 | 18 | 24 | 0 | 0 | 3 | 0 | 0 |
| D13-1049 | 3"ID | 3"ID | 8.5 | 31.5 | 38.5 | 0 | 0 | 3.5 | 0 | 0 |
| D14-0204 | 3"ID | 3"OD | 8.5 | 34 | 40 | 0 | 0 | 3 | 0 | 0 |
| D13-7635 | 3"ID | 3"ID | 9 | 10 | 16 | 0 | 0 | 3 | 0 | 0 |
| D99-0082 | 3"ID | 3"OD | 9 | 13 | 20 | 0 | 0 | 3 | 0 | 0 |
| D13-0053 | 3"ID | 3"ID | 9 | 23 | 35 | 0 | 0 | 9 | 0 | 0 |
| D14-0913 | 3"ID | 3"OD | 10 | 7 | 13 | 0 | 0 | 3 | 0 | 0 |
| D14-0993 | 3"ID | 3.5"ID | 10 | 25 | 31 | 0 | 0 | 3 | 0 | 0 |
| D14-0170 | 3"ID | 2.75"OD | 4.25x8.75 | 16 | 46 | 0 | 0 | 3 | 0 | 0 |
| D14-0225 | 3"ID | 3"ID | 4.25x8.75 | 27.5 | 46 | 0 | 0 | 4 | 0 | 0 |
| D14-0580 | 3"ID | 2"ID | 4.25x8.75 | 36 | 46 | 0 | 0 | 3.5 | 0 | 0 |
| D14-0949 | 3"ID | 3"OD | 6x10 | 18 | 25.5 | 0 | 0 | 3 | 0 | 0 |
| D13-1501 | 3"ID | 3"ID | 8.25x11.5 | 25 | 32 | 3 | 3 | 3.5 | 12 | 12 |
| D10-0901 | 3"OD | 3"OD | 4 | 18 | 20 | 0 | 0 | 1 | 0 | 0 |
| D14-0840 | 3"OD | 2.5"ID | 6 | 20 | 26.25 | 0 | 0 | 3.25 | 0 | 0 |
| D13-0073 | 3"OD | 3"ID | 6 | 21 | 28 | 0 | 0 | 3.5 | 0 | 0 |

mufflers

TYPE 1
CENTER IN
CENTER OUT

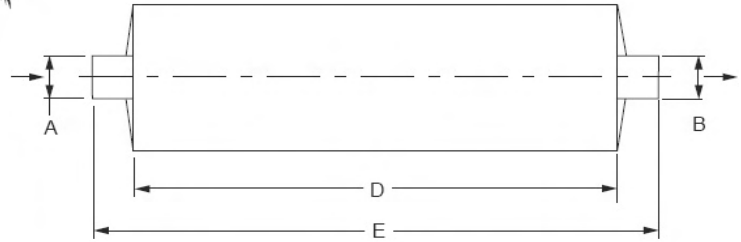
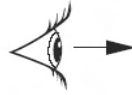
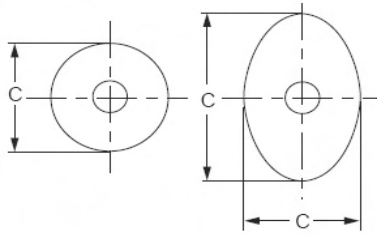

INLET/OUTLET CLOCK POSITIONS

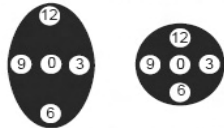

OVAL MUFFLER ROUND MUFFLER

Note: All clock positions are determined by viewing the muffler from the end view, nearest the inlet.

| PART# NUMBER | A INLET SIZE | B OUTLET SIZE | C BODY SIZE | D BODY LENGTH | E OVERALL LENGTH | F INLET OFFSET | G OUTLET OFFSET | H INLET LENGTH | INLET CLOCK POSITION | OUTLET CLOCK POSITION |
|-----------------|--------------------|---------------------|-------------------|---------------------|------------------------|----------------------|-----------------------|----------------------|----------------------------|-----------------------------|
| D14-0195 | 3"OD | 3"OD | 7 | 26.5 | 28.5 | 0 | 0 | 1 | 0 | 0 |
| D14-0168 | 3"OD | 3.5"OD | 8 | 24 | 32 | 0 | 0 | 4 | 0 | 0 |
| D14-0393 | 3"OD | 3"OD | 9 | 44 | 51 | 0 | 0 | 3.5 | 0 | 0 |
| D99-0093 | 3"OD | 3"OD | 10 | 23 | 30 | 0 | 0 | 3.5 | 0 | 0 |
| D99-0102 | 3.125"ID | 3"OD | 11 | 28 | 35 | 0 | 0 | 3.5 | 0 | 0 |
| D14-0081 | 3.15"ID | 3.15"ID | 6x10 | 12 | 19 | 0 | 0 | 3 | 0 | 0 |
| D13-0033 | 3.18"ID | 3.18"ID | 10 | 23 | 28.5 | 0 | 0 | 2.5 | 0 | 0 |
| D14-0758 | 3.25"ID | 3.5"ID | 7 | 20 | 28 | 0 | 0 | 3.75 | 0 | 0 |
| D14-0054 | 3.5"FL | 3.5"ID | 7 | 30 | 36 | 0 | 0 | 2.5 | 0 | 0 |
| D14-0208 | 3.5"ID | 3"OD | 6 | 19.5 | 28 | 0 | 0 | 5.5 | 0 | 0 |
| D13-1167 | 3.5"ID | 3.5"ID | 6 | 26 | 31 | 0 | 0 | 2.5 | 0 | 0 |
| D15-0006 | 3.5"ID | 3.5"ID | 7 | 9 | 16.5 | 0 | 0 | 2 | 0 | 0 |
| D14-0839 | 3.5"ID | 3.5"ID | 7 | 12 | 20 | 0 | 0 | 5 | 0 | 0 |
| D14-0737 | 3.5"ID | 4"ID | 7 | 16 | 27 | 0 | 0 | 9.5 | 0 | 0 |
| D14-0155 | 3.5"ID | 3"OD | 7 | 18 | 28 | 0 | 0 | 5 | 0 | 0 |
| D13-0037 | 3.5"ID | 3.5"ID | 7 | 22 | 29 | 0 | 0 | 3 | 0 | 0 |
| D99-0095 | 3.5"ID | 3.5"ID | 7 | 22 | 54 | 0 | 0 | 16 | 0 | 0 |
| D13-0164 | 3.5"ID | 3.5"ID | 7 | 30 | 40 | 0 | 0 | 5 | 0 | 0 |
| D13-1591 | 3.5"ID | 3.5"F | 7 | 41 | 45.5 | 0 | 0 | 2.75 | 0 | 0 |
| D14-0128 | 3.5"ID | 3"ID | 8 | 16 | 22 | 1.25 | 1.5 | 3 | 6 | 6 |
| D14-0099 | 3.5"ID | 3.5"ID | 8 | 20 | 26.5 | 0 | 0 | 3.25 | 0 | 0 |
| D13-0061 | 3.5"ID | 3.5"OD | 8.5 | 12 | 19 | 0 | 0 | 3.5 | 0 | 0 |
| D13-0110 | 3.5"ID | 4"ID | 8.5 | 29.5 | 36 | 0 | 0 | 3 | 0 | 0 |
| D13-3500 | 3.5"ID | 3.5"ID | 8.5 | 29.5 | 37 | 0 | 0 | 3.5 | 0 | 0 |
| D16-0003 | 3.5"ID | 3.5" | 9 | 11.5 | 16.5 | 0 | 0 | 1 | 0 | 0 |
| D14-0487 | 3.5"ID | 3.5"ID | 9 | 15 | 22 | 0 | 0 | 3.5 | 0 | 0 |
| D13-0118 | 3.5"ID | 4"ID | 9 | 24 | 28 | 18 | 2 | 4 | 12 | 6 |
| D14-0516 | 3.5"ID | 3"ID | 9 | 26 | 31 | 1.75 | 0 | 2.5 | 12 | 0 |
| D13-3522 | 3.5"ID | 3.5"ID | 9 | 44 | 51 | 0 | 0 | 3.5 | 0 | 0 |
| D13-3590 | 3.5"ID | 3.5"ID | 9 | 44 | 52 | 0 | 0 | 3.5 | 0 | 0 |
| D14-0012 | 3.5"ID | 5"ID | 10 | 39 | 47 | 0 | 0 | 3.5 | 0 | 0 |
| D14-0713 | 3.5"ID | 3.5"OD | 4.5x11 | 31 | 37 | 0 | 0 | 3 | 0 | 0 |

mufflers

TYPE 1 CENTER IN CENTER OUT

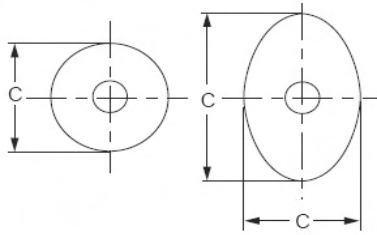

INLET/OUTLET CLOCK POSITIONS

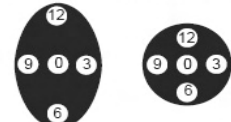

OVAL MUFFLER ROUND MUFFLER

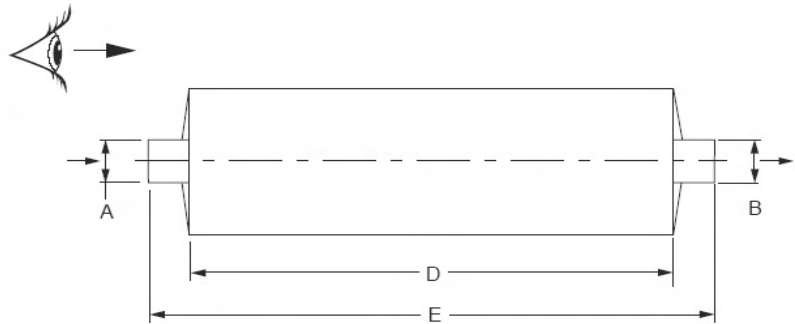

Note: All clock positions are determined by viewing the muffler from the end view, nearest the inlet.

| PART# NUMBER | A INLET SIZE | B OUTLET SIZE | C BODY SIZE | D BODY LENGTH | E OVERALL LENGTH | F INLET OFFSET | G OUTLET OFFSET | H INLET LENGTH | INLET CLOCK POSITION | OUTLET CLOCK POSITION |
|-----------------|--------------------|---------------------|-------------------|---------------------|------------------------|----------------------|-----------------------|----------------------|----------------------------|-----------------------------|
| D12-0109 | 3.5"ID | 3.5"ID | 4.25x8.75 | 22 | 26 | 0 | 0 | 2.5 | 0 | 0 |
| D14-0199 | 3.5"ID | 3.5"OD | 8.25x11.5 | 24 | 37 | 0 | 0 | 8.75 | 0 | 0 |
| D14-0818 | 3.5"IDFL | 3.5"ODTP | 8.5DW | 32.25 | 44.5 | 0 | 0 | 2.85 | 0 | 0 |
| D13-7595 | 3.5"NPT | 3.5"NPT | 7 | 15 | 20 | 0 | 0 | 2.4 | 0 | 0 |
| D14-0212 | 3.5"OD | 3.5"OD | 7 | 14.5 | 21 | 0 | 0 | 3.25 | 0 | 0 |
| D14-0694 | 3.5"OD | 3.5"OD | 7 | 27 | 38 | 0 | 0 | 6 | 0 | 0 |
| D14-0530 | 3.5"OD | 3.5"OD | 8 | 12.5 | 17.5 | 0 | 0 | 2.5 | 0 | 0 |
| D12-2021 | 3.5"OD | 3"OD | 8 | 38 | 47 | 0 | 0 | 5 | 0 | 0 |
| D13-0046 | 3.5"OD | 4"OD | 11 | 44 | 51 | 0 | 0 | 3.5 | 0 | 0 |
| D14-0201 | 3.7"ID | 4"OD | 6 | 30 | 43.5 | 0 | 0 | 10.5 | 0 | 0 |
| D14-0177 | 3.75"FL | 3"OD ASP | 4.5x11 | 30 | 37 | 0 | 0 | 3 | 0 | 0 |
| D14-0810 | 3.75"ID | 3.75"OD | 6 | 31 | 38 | 0 | 0 | 3.5 | 0 | 0 |
| D14-0482 | 3.75"ID | 3.75"ID | 8.25x11.5 | 26.5 | 34.5 | 0 | 0 | 4 | 0 | 0 |
| D14-0750 | 3.875"OD | 3.875"OD | 8 | 22 | 32 | 0 | 0 | 6 | 0 | 0 |
| D14-0258 | 4"F | 5"OD | 8.5 | 36 | 74 | 0 | 0 | 14 | 0 | 0 |
| D14-0246 | 4"FL | 3"OD | 7 | 25 | 49 | 0 | 0 | 7 | 0 | 0 |
| D13-1588 | 4"FL | 4"ID | 8.5 | 32 | 37 | 0 | 0 | 1 | 0 | 0 |
| D14-0245 | 4"FL | 4"OD | 12 | 21 | 29 | 0 | 0 | 5 | 0 | 0 |
| D14-0213 | 4"ID | 4.5"OD | 6 | 18 | 24 | 0 | 0 | 3 | 0 | 0 |
| D14-0473 | 4"ID | 3"OD | 6 | 18.5 | 24.5 | 0 | 0 | 3 | 0 | 0 |
| D13-1184 | 4"ID | 4"ID | 6 | 32 | 46 | 0 | 0 | 7 | 0 | 0 |
| D13-1090 | 4"ID | 4"ID | 6 | 44 | 51 | 0 | 0 | 3.5 | 0 | 0 |
| D13-1135 | 4"ID | 4"ID | 7 | 14 | 20 | 0 | 0 | 3 | 0 | 0 |
| D16-0004 | 4"ID | 4"ID | 7 | 17.5 | 22 | 0 | 0 | 2.25 | 0 | 0 |
| D14-0089 | 4"ID | 4.125"ID | 7 | 18 | 25.5 | 0 | 0 | 3 | 0 | 0 |
| D14-0097 | 4"ID | 4"ID | 7 | 19 | 28.5 | 0 | 0 | 6 | 0 | 0 |
| D13-1188 | 4"ID | 4"ID | 7 | 22 | 28 | 0 | 0 | 3 | 0 | 0 |
| D99-0161 | 4"ID | 4"ID | 7 | 22 | 28 | 0 | 0 | 3 | 0 | 0 |
| D14-0148 | 4"ID | 4"ID | 7 | 26.5 | 37 | 1 | 1 | 5.5 | 0 | 0 |
| D14-0437 | 4"ID | 4.125"OD | 7 | 26.5 | 35.5 | 0 | 0 | 4 | 0 | 0 |
| D14-0528 | 4"ID | 4"ID | 7 | 26.5 | 33.5 | 0 | 0 | 3.5 | 0 | 0 |
| D13-1597 | 4"ID | 4"ID | 7 | 33 | 39 | 0 | 0 | 3 | 0 | 0 |

mufflers

TYPE 1
CENTER IN
CENTER OUT

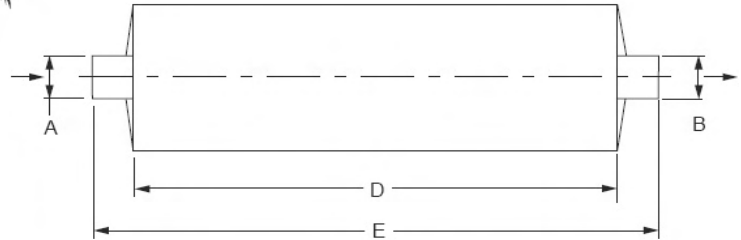
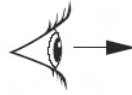
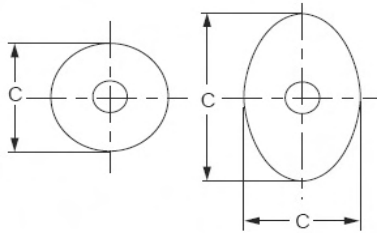

INLET/OUTLET CLOCK POSITIONS

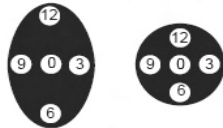

OVAL MUFFLER ROUND MUFFLER

Note: All clock positions are determined by viewing the muffler from the end view, nearest the inlet.

| PART# NUMBER | A INLET SIZE | B OUTLET SIZE | C BODY SIZE | D BODY LENGTH | E OVERALL LENGTH | F INLET OFFSET | G OUTLET OFFSET | H INLET LENGTH | INLET CLOCK POSITION | OUTLET CLOCK POSITION |
|-----------------|--------------------|---------------------|-------------------|---------------------|------------------------|----------------------|-----------------------|----------------------|----------------------------|-----------------------------|
| D13-1179 | 4"ID | 4"ID | 7 | 38 | 44 | 0 | 0 | 3 | 0 | 0 |
| D14-0690 | 4"ID | 4"ID | 8 | 10 | 21 | 0 | 0 | 5 | 0 | 0 |
| D15-0007 | 4"ID | 4"ID | 8 | 10.63 | 18.13 | 0 | 0 | 2 | 0 | 0 |
| D13-1104 | 4"ID | 4"ID | 8 | 24 | 30.5 | 0 | 0 | 3.25 | 0 | 0 |
| D14-0302 | 4"ID | 4"OD | 8.5 | 12 | 19 | 0 | 0 | 2.5 | 0 | 0 |
| D14-0531 | 4"ID | 4"ID | 8.5 | 20 | 26.5 | 0 | 0 | 3 | 0 | 0 |
| D13-0122 | 4"ID | 4"ID | 8.5 | 24 | 31 | 0 | 0 | 3.5 | 0 | 0 |
| D13-4060 | 4"ID | 4"ID | 8.5 | 33 | 40 | 0 | 0 | 3.5 | 0 | 0 |
| D16-0001 | 4"ID | 4"ID | 9 | 11.5 | 16 | 0 | 0 | 2.5 | 0 | 0 |
| D14-0115 | 4"ID | 4"OD | 9 | 15 | 23 | 0 | 0 | 4 | 0 | 0 |
| D14-0028 | 4"ID | 5"OD | 9 | 18 | 24 | 0 | 0 | 2.5 | 0 | 0 |
| D13-7637 | 4"ID | 4"ID | 9 | 20 | 27 | 0 | 0 | 3.5 | 0 | 0 |
| D14-0078 | 4"ID | 4"OD | 9 | 20 | 28 | 0 | 0 | 4 | 0 | 0 |
| D14-0462 | 4"ID | 4"OD | 9 | 21 | 26.5 | 0 | 0 | 2.75 | 0 | 0 |
| D14-0533 | 4"ID | 4"ID | 9 | 24 | 34 | 0 | 0 | 5.5 | 0 | 0 |
| D13-7638 | 4"ID | 4"ID | 9 | 28 | 34.5 | 0 | 0 | 3.5 | 0 | 0 |
| D13-0012 | 4"ID | 5"ID | 9 | 44 | 51 | 0 | 0 | 3 | 0 | 0 |
| D13-0196 | 4"ID | 4"ID | 9 | 44 | 52 | 0 | 0 | 3 | 0 | 0 |
| D13-2015 | 4"ID | 4"ID | 9 | 44 | 51 | 0 | 0 | 3.5 | 0 | 0 |
| D13-4095 | 4"ID | 5"ID | 9 | 44 | 51.5 | 0 | 0 | 3 | 0 | 0 |
| D13-4590 | 4"ID | 4"ID | 9 | 44 | 52 | 0 | 0 | 3.5 | 0 | 0 |
| D13-4595 | 4"ID | 5"ID | 9 | 44 | 51.5 | 0 | 0 | 3.5 | 0 | 0 |
| D14-0506 | 4"ID | 4"ID | 9 | 44 | 51 | 0 | 0 | 3.5 | 0 | 0 |
| D13-2003 | 4"ID | 4"ID | 9 | 44.5 | 51 | 0 | 0 | 3 | 0 | 0 |
| D13-2004 | 4"ID | 4"ID | 9 | 44.5 | 51 | 0 | 0 | 2.5 | 0 | 0 |
| D13-4591 | 4"ID | 4"ID | 9 | 44.5 | 51 | 0 | 0 | 3.5 | 0 | 0 |
| D14-0457 | 4"ID | 4"OD | 10 | 31 | 47 | 0 | 0 | 4 | 0 | 0 |
| D13-4525 | 4"ID | 4"ID | 10 | 34 | 41 | 0 | 0 | 3.5 | 0 | 0 |
| D99-0129 | 4"ID | 4"ID | 10 | 34 | 43 | 0 | 0 | 3.5 | 0 | 0 |
| D13-1175 | 4"ID | 4"OD | 10 | 36 | 43 | 0 | 0 | 3.5 | 0 | 0 |
| D13-4015 | 4"ID | 5"ID | 10 | 44 | 51.5 | 0 | 0 | 3 | 0 | 0 |
| D13-4510 | 4"ID | 4"ID | 10 | 44 | 52 | 0 | 0 | 3.5 | 0 | 0 |

mufflers

TYPE 1
CENTER IN
CENTER OUT

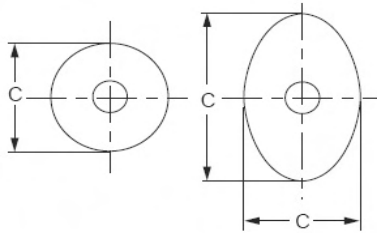

INLET/OUTLET CLOCK POSITIONS

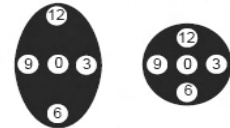

OVAL MUFFLER ROUND MUFFLER

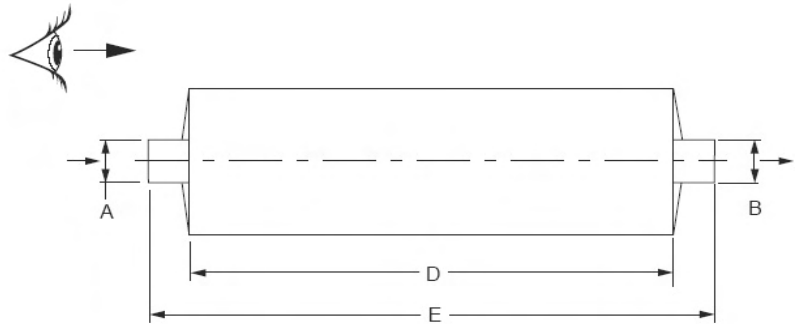

Note: All clock positions are determined by viewing the muffler from the end view, nearest the inlet.

| PART# NUMBER | A INLET SIZE | B OUTLET SIZE | C BODY SIZE | D BODY LENGTH | E OVERALL LENGTH | F INLET OFFSET | G OUTLET OFFSET | H INLET LENGTH | INLET CLOCK POSITION | OUTLET CLOCK POSITION |
|-----------------|--------------------|---------------------|-------------------|---------------------|------------------------|----------------------|-----------------------|----------------------|----------------------------|-----------------------------|
| D13-4515 | 4"ID | 5"ID | 10 | 44 | 51 | 0 | 0 | 3.5 | 0 | 0 |
| D14-0166 | 4"ID | 4"ID | 10 | 44 | 51 | 0 | 0 | 3.5 | 0 | 0 |
| D13-0045 | 4"ID | 4"ID | 11 | 30 | 37 | 0 | 0 | 3.5 | 0 | 0 |
| D13-1510 | 4"ID | 4"ID | 11 | 34 | 40 | 0 | 0 | 3 | 0 | 0 |
| D99-0087 | 4"ID | 4"ID | 11 | 36 | 43 | 0 | 0 | 3.5 | 0 | 0 |
| D14-0715 | 4"ID | 4"ID | 12 | 27.5 | 36.5 | 3 | 3 | 4.5 | 6 | 6 |
| D13-0145 | 4"ID | 4"ID | 12 | 40 | 46.5 | 0 | 0 | 3 | 0 | 0 |
| D14-0479 | 4"ID | 4"ID | 12 | 40 | 46 | 0 | 0 | 3 | 0 | 0 |
| D13-1045 | 4"ID | 4"ID | 10DW | 44 | 52 | 0 | 0 | 4 | 0 | 0 |
| D13-0079 | 4"ID | 4"ID | 10 | 36 | 43 | 0 | 0 | 3.5 | 0 | 0 |
| D14-0143 | 4"ID | 4"ID | 4.5x11 | 29.5 | 36 | 0 | 0 | 3.25 | 0 | 0 |
| D14-0805 | 4"IDFL | 4"IDTP | 6 | 60 | 60 | 0 | 0 | 0 | 0 | 0 |
| D13-2032 | 4"NPT | 4"NPT | 8.5 | 20 | 26 | 0 | 0 | 3 | 0 | 0 |
| D13-1067 | 4"OD | 4"OD | 8 | 24 | 38 | 0 | 0 | 8 | 0 | 0 |
| D13-1579 | 4"OD | 4"OD | 8 | 30 | 40 | 0 | 0 | 5 | 0 | 0 |
| D14-0657 | 4"OD | 4"OD | 10 | 20 | 26 | 0 | 0 | 3 | 0 | 0 |
| D14-0644 | 4"OD | 4"OD | 10 | 23 | 30 | 0 | 0 | 3.5 | 0 | 0 |
| D14-0769 | 4"OD | 5"OD | 10 | 28 | 34.5 | 0 | 0 | 3 | 0 | 0 |
| D13-1132 | 4"OD | 4"OD | 12 | 24 | 31.5 | 0 | 0 | 4 | 0 | 0 |
| D14-0977 | 4"OD | 3.94"OD | 6x10 | 32 | 37.75 | 0 | 0 | 2.75 | 0 | 0 |
| D14-0972 | 4"ODFL | 4"OD | 4.5x11 | 30 | 37 | 0 | 0 | 3 | 0 | 0 |
| D14-0183 | 4.25"ID | 4.5"OD ASP | 7 | 26.5 | 45 | 0 | 0 | 12.5 | 0 | 0 |
| D14-0957 | 4.25"ID | 5"OD | 9 | 18 | 26.5 | 0 | 0 | 3 | 0 | 0 |
| D14-0003 | 4.375"ID | 4.5"OD | 8 | 17.75 | 24.75 | 0 | 0 | 3.5 | 0 | 0 |
| D14-0463 | 4.3FL | 3.5"OD | 4.25x8.75 | 31 | 42 | 0 | 0 | 3.5 | 0 | 0 |
| D14-0079 | 4.4"ID | 4.5"OD | 6x10 | 17.5 | 27 | 0 | 0 | 3 | 0 | 0 |
| D14-0064 | 4.465"ID | 4.5"OD | 9 | 18 | 27 | 0 | 0 | 4 | 0 | 0 |
| D14-0093 | 4.5"FL | 4"OD | 7 | 24 | 30.5 | 0 | 0 | 3.5 | 0 | 0 |
| D14-0796 | 4.5"ID | 4.5"ID | 9 | 14 | 19.75 | 0 | 0 | 2.125 | 0 | 0 |
| D14-0062 | 4.5"ID | 4.5"ID | 9 | 18 | 29 | 0 | 0 | 5 | 0 | 0 |
| D14-0477 | 4.5"ID | 4.5"OD | 9 | 18 | 28 | 0 | 0 | 5 | 0 | 0 |
| D14-0866 | 4.5"ID | 5"OD | 9 | 20 | 33.5 | 0 | 0 | 8.5 | 0 | 0 |

mufflers

TYPE 1
CENTER IN
CENTER OUT

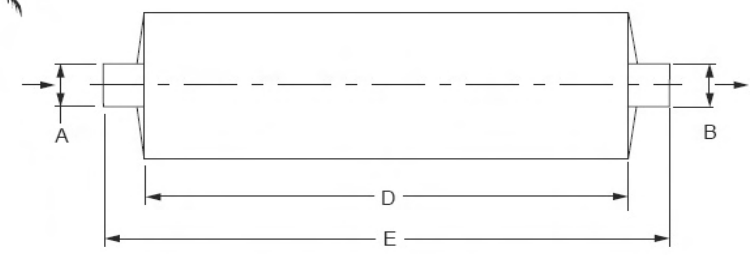
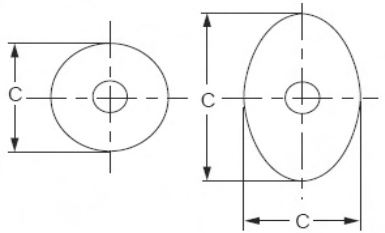

INLET/OUTLET CLOCK POSITIONS

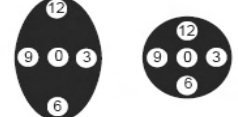

OVAL MUFFLER ROUND MUFFLER

Note: All clock positions are determined by viewing the muffler from the end view, nearest the inlet.

| PART# NUMBER | A INLET SIZE | B OUTLET SIZE | C BODY SIZE | D BODY LENGTH | E OVERALL LENGTH | F INLET OFFSET | G OUTLET OFFSET | H INLET LENGTH | INLET CLOCK POSITION | OUTLET CLOCK POSITION |
|-----------------|--------------------|---------------------|-------------------|---------------------|------------------------|----------------------|-----------------------|----------------------|----------------------------|-----------------------------|
| D13-1145 | 4.5"ID | 4.5"ID | 12 | 22 | 31 | 0 | 0 | 4.5 | 0 | 0 |
| D14-1002 | 4.75"ID | 5"OD | 11 | 40 | 54 | 0 | 0 | 3.5 | 0 | 0 |
| D14-0880 | 4.84"ID | 5"OD | 8.25x11.5 | 36 | 44 | 0 | 0 | 4 | 0 | 0 |
| D14-0386 | 4.875"FL | 5"ID ASP | 8.25x11.5 | 27.5 | 36 | 0 | 0 | 5 | 0 | 0 |
| D14-0129 | 4.875"ID | 5"OD | 11 | 26 | 32 | 0 | 0 | 3.5 | 0 | 0 |
| D14-0736 | 5"F | 5"OD ASP | 9 | 42.5 | 52.5 | 0 | 0 | 5.5 | 0 | 0 |
| D14-0211 | 5"FL | 5"OD | 10 | 36 | 46 | 0 | 0 | 4 | 0 | 0 |
| D13-1572 | 5"ID | 5"ID | 6 | 44 | 51 | 0 | 0 | 3 | 0 | 0 |
| D13-1133 | 5"ID | 5"ID | 7 | 12 | 19 | 0 | 0 | 3.5 | 0 | 0 |
| D13-1139 | 5"ID | 5"ID | 7 | 12 | 18 | 0 | 0 | 3 | 0 | 0 |
| D13-1036 | 5"ID | 5"ID | 7 | 26 | 32 | 0 | 0 | 3 | 0 | 0 |
| D13-1084 | 5"ID | 5"ID | 7 | 44 | 51 | 0 | 0 | 3.5 | 0 | 0 |
| D13-1186 | 5"ID | 5"ID | 8 | 39 | 46.5 | 1 | 1 | 4 | 12 | 12 |
| D13-1519 | 5"ID | 5"ID | 8 | 44 | 51 | 0 | 0 | 3.5 | 0 | 3 |
| D16-0002 | 5"ID | 5"ID | 9 | 11.5 | 16.5 | 0 | 0 | 2.5 | 0 | 0 |
| D15-0008 | 5"ID | 5"ID | 9 | 11.75 | 20.75 | 0 | 0 | 2 | 0 | 0 |
| D13-0123 | 5"ID | 5"ID | 9 | 23 | 30 | 0 | 0 | 3.5 | 0 | 0 |
| D13-1130 | 5"ID | 5"ID | 9 | 26.5 | 33.5 | 1 | 1 | 3.5 | 0 | 0 |
| D13-1040 | 5"ID | 5"ID | 9 | 31 | 37 | 0 | 0 | 3 | 0 | 0 |
| D13-7650 | 5"ID | 5"ID | 9 | 33.5 | 40 | 0 | 0 | 3 | 0 | 0 |
| D14-0069 | 5"ID | 5"ID | 9 | 33.5 | 40 | 0 | 0 | 3.25 | 0 | 0 |
| D13-5090 | 5"ID | 5"ID | 9 | 44 | 52 | 0 | 0 | 3.5 | 0 | 0 |
| D13-5590 | 5"ID | 5"ID | 9 | 44 | 52 | 0 | 0 | 3.5 | 0 | 0 |
| D14-0448 | 5"ID | 6"ID | 9 | 44 | 51 | 0 | 0 | 3.5 | 0 | 0 |
| D13-2001 | 5"ID | 5"ID | 9 | 44.5 | 51 | 0 | 0 | 3 | 0 | 0 |
| D13-2016 | 5"ID | 5"ID | 9 | 44.5 | 51 | 0 | 0 | 3 | 0 | 0 |
| D14-0553 | 5"ID | 5"OD | 10 | 15 | 23.25 | 0 | 0 | 3.5 | 0 | 0 |
| D14-0455 | 5"ID | 5"ID | 10 | 21 | 38 | 0 | 0 | 8.5 | 0 | 0 |
| D13-0138 | 5"ID | 5"ID | 10 | 24 | 31 | 0 | 0 | 3.5 | 0 | 0 |
| D13-0183 | 5"ID | 5"ID | 10 | 33 | 40 | 0 | 0 | 3.5 | 0 | 0 |
| D13-1098 | 5"ID | 6"ID | 10 | 34.5 | 41.5 | 0 | 0 | 3.5 | 0 | 0 |
| D13-1082 | 5"ID | 6"ID | 10 | 44 | 51 | 0 | 0 | 3.5 | 0 | 0 |

mufflers

TYPE 1
CENTER IN
CENTER OUT

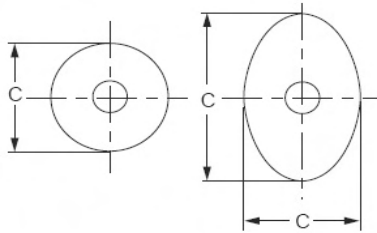

INLET/OUTLET CLOCK POSITIONS

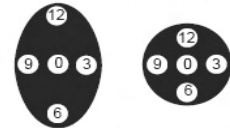

OVAL MUFFLER ROUND MUFFLER

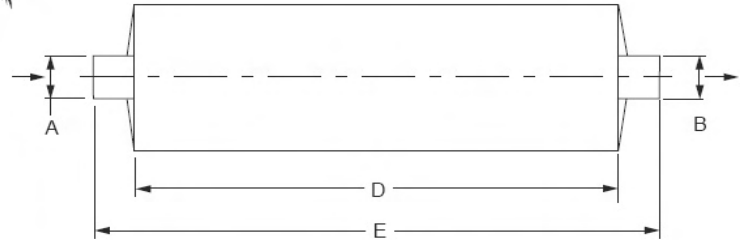
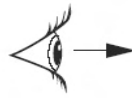

Note: All clock positions are determined by viewing the muffler from the end view, nearest the inlet.

| PART# NUMBER | A INLET SIZE | B OUTLET SIZE | C BODY SIZE | D BODY LENGTH | E OVERALL LENGTH | F INLET OFFSET | G OUTLET OFFSET | H INLET LENGTH | INLET CLOCK POSITION | OUTLET CLOCK POSITION |
|-----------------|--------------------|---------------------|-------------------|---------------------|------------------------|----------------------|-----------------------|----------------------|----------------------------|-----------------------------|
| D13-1567 | 5"ID | 5"ID | 10 | 44 | 53 | 0 | 0 | 3 | 0 | 0 |
| D13-2037 | 5"ID | 5"ID | 10 | 44 | 51 | 0 | 0 | 3.5 | 0 | 0 |
| D13-2089 | 5"ID | 5"ID | 10 | 44 | 51 | 0 | 0 | 3.5 | 0 | 0 |
| D13-5010 | 5"ID | 5"ID | 10 | 44 | 51.5 | 0 | 0 | 3.5 | 0 | 0 |
| D13-5510 | 5"ID | 5"ID | 10 | 44 | 51 | 0 | 0 | 3.5 | 0 | 0 |
| D13-5512 | 5"ID | 5"ID | 10 | 44 | 51 | 0 | 0 | 3 | 0 | 0 |
| D15-0092 | 5"ID | 5"ID | 10 | 44 | 51.5 | 0 | 0 | 3.75 | 0 | 0 |
| D99-0084 | 5"ID | 5"ID | 10 | 44 | 51 | 0 | 0 | 3.5 | 0 | 0 |
| D99-0111 | 5"ID | 5"ID | 10 | 44 | 51 | 0 | 0 | 3.5 | 0 | 0 |
| D13-2038 | 5"ID | 5"ID | 10 | 44.5 | 51 | 0 | 0 | 3 | 0 | 0 |
| D13-2075 | 5"ID | 6"ID | 10 | 44.5 | 51 | 0 | 0 | 3 | 0 | 0 |
| D13-7616 | 5"ID | 5"ID | 10 | 44.5 | 51 | 0 | 0 | 3 | 0 | 0 |
| D13-7697 | 5"ID | 5"ID | 10 | 44.5 | 51 | 0 | 0 | 3 | 0 | 0 |
| D13-7698 | 5"ID | 5"ID | 10 | 44.5 | 51 | 0 | 0 | 3 | 0 | 0 |
| D13-0025 | 5"ID | 5"ID | 10 | 53 | 61 | 0 | 0 | 3.25 | 0 | 0 |
| D13-5520 | 5"ID | 5"ID | 10 | 59 | 67 | 0 | 0 | 3.5 | 0 | 0 |
| D13-0116 | 5"ID | 5"ID | 11 | 24 | 31 | 0 | 0 | 3.5 | 0 | 0 |
| D14-0777 | 5"ID | 5"OD | 11 | 24 | 33.5 | 0 | 0 | 6 | 0 | 0 |
| D13-1157 | 5"ID | 5"ID | 11 | 51 | 57 | 0 | 0 | 3 | 0 | 0 |
| D13-0043 | 5"ID | 5"OD | 12 | 24 | 40 | 0 | 0 | 4 | 0 | 0 |
| D13-0144 | 5"ID | 5"ID | 12 | 41.5 | 48.5 | 0 | 0 | 3.5 | 0 | 0 |
| D14-0729 | 5"ID | 5"ID | 12 | 44 | 51 | 0 | 0 | 3.5 | 0 | 0 |
| D14-0925 | 5"ID | 5"ID | 12 | 50 | 57 | 0 | 0 | 3 | 0 | 0 |
| D13-1023 | 5"ID | 5"ID | 10x15 | 30 | 37 | 0 | 0 | 3.5 | 0 | 0 |
| D14-0503 | 5"ID | 5"ID | 8.25x11.5 | 38 | 46 | 0 | 0 | 4 | 0 | 0 |
| D13-1051 | 5"OD | 5"OD | 6 | 16 | 24 | 0 | 0 | 4 | 0 | 0 |
| D14-0004 | 5"OD | 5"ID | 6 | 30 | 37.5 | 0 | 0 | 4 | 0 | 0 |
| D13-1077 | 5"OD | 5"OD | 7 | 39 | 50 | 0.5 | 0.5 | 5 | 12 | 12 |
| D14-0755 | 5"OD | 5"OD | 8 | 16 | 22 | 0 | 0 | 3 | 0 | 0 |
| D13-1061 | 5"OD | 5"OD | 9 | 16 | 30 | 0 | 0 | 4.5 | 0 | 0 |
| D13-1046 | 5"OD | 5"OD | 9 | 16.25 | 21.875 | 0 | 0 | 2.75 | 0 | 0 |
| D13-1138 | 5"OD | 5"OD | 9 | 19.75 | 32 | 0 | 0 | 6 | 0 | 0 |

mufflers

TYPE 1
CENTER IN
CENTER OUT

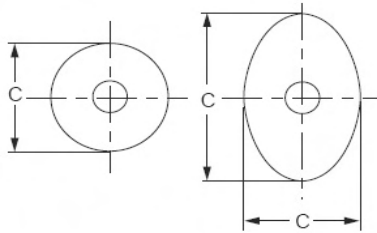

INLET/OUTLET CLOCK POSITIONS

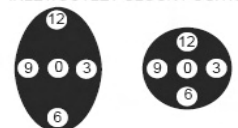

OVAL MUFFLER ROUND MUFFLER

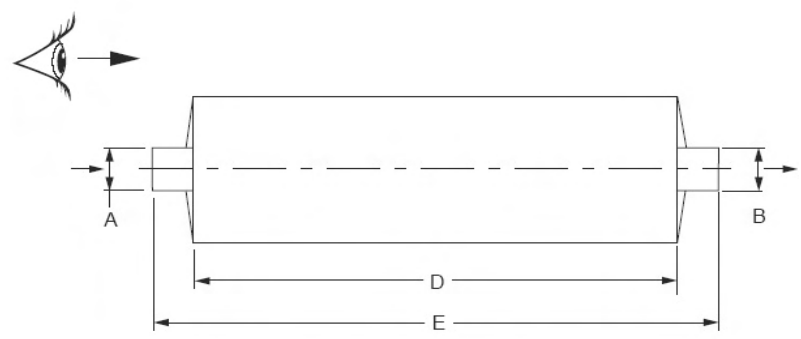

Note: All clock positions are determined by viewing the muffler from the end view, nearest the inlet.

| PART# NUMBER | A INLET SIZE | B OUTLET SIZE | C BODY SIZE | D BODY LENGTH | E OVERALL LENGTH | F INLET OFFSET | G OUTLET OFFSET | H INLET LENGTH | INLET CLOCK POSITION | OUTLET CLOCK POSITION |
|-----------------|--------------------|---------------------|-------------------|---------------------|------------------------|----------------------|-----------------------|----------------------|----------------------------|-----------------------------|
| D13-1185 | 5"OD | 5"OD | 10 | 22 | 28 | 0 | 0 | 3 | 0 | 0 |
| D13-3592 | 5"OD | 5"OD | 10 | 29.5 | 40 | 0 | 0 | 5.25 | 0 | 0 |
| D13-1052 | 5"OD | 5"OD | 10 | 34 | 42 | 0 | 0 | 4 | 0 | 0 |
| D13-1561 | 5"OD | 5"OD | 11 | 30 | 38 | 0 | 0 | 4 | 0 | 0 |
| D14-0544 | 5"OD | 5"OD | 12 | 26 | 50 | 0 | 0 | 12 | 0 | 0 |
| D14-0667 | 5"OD | 6"EL | 12 | 30 | 47 | 0 | 0 | 5 | 0 | 0 |
| D14-0833 | 5"OD | 5"OD | 12 | 32 | 40 | 0 | 0 | 4 | 0 | 0 |
| D14-0567 | 5.5"ID | 5.5"ID | 10 | 32.5 | 40 | 0 | 0 | 3.5 | 0 | 0 |
| D14-0659 | 6"EL | 5.125"OD ASP | 9 | 41 | 61 | 0 | 0 | 12 | 0 | 0 |
| D14-0768 | 6"ID | 4"OD | 6 | 20 | 38 | 0 | 0 | 0 | 0 | 0 |
| D13-1577 | 6"ID | 6"ID | 7 | 23 | 30 | 0 | 0 | 3 | 0 | 0 |
| D14-0625 | 6"ID | 6"OD | 7 | 34 | 44 | 0 | 0 | 6 | 0 | 0 |
| D14-0666 | 6"ID | 6"ID | 8 | 47 | 54 | 0 | 0 | 3 | 0 | 0 |
| D13-1190 | 6"ID | 6"ID | 10 | 14 | 20 | 0 | 0 | 3 | 0 | 0 |
| D14-0978 | 6"ID | 6"OD | 10 | 38.5 | 54.5 | 0 | 0 | 8 | 0 | 0 |
| D13-1044 | 6"ID | 6"ID | 10 | 44 | 51 | 0 | 0 | 3.5 | 0 | 0 |
| D13-1111 | 6"ID | 6"ID | 10 | 44 | 51 | 0 | 0 | 3.5 | 0 | 0 |
| D14-0145 | 6"ID | 6"ID | 10 | 44 | 51 | 0 | 0 | 3.5 | 0 | 0 |
| D14-0209 | 6"ID | 6"ID | 10 | 44 | 51 | 0 | 0 | 3 | 0 | 0 |
| D15-0009 | 6"ID | 6.13 | 12 | 22 | 27 | 0 | 0 | 2 | 0 | 0 |
| D14-0251 | 6"ID | 6"OD | 12 | 24 | 31 | 0 | 0 | 3.5 | 0 | 0 |
| D14-0647 | 6.5"ID | 5"OD | 10 | 26 | 34.5 | 0 | 0 | 3.5 | 0 | 0 |
| D14-0238 | 6.75"ID | 6.75"ID | 11 | 35 | 47 | 0 | 0 | 6 | 0 | 0 |
| D14-0489 | 8"ID | 8"ID | 16 | 30 | 37 | 0 | 0 | 3.5 | 0 | 0 |
| D14-0723 | 8"ID | 8"ID | 10x15DW | 34 | 41.5 | 0 | 0 | 3.5 | 0 | 0 |
| D14-0962 | 8"OD | 8"OD | 12 | 38 | 45 | 0 | 0 | 3.5 | 0 | 0 |